

Dimensions

Height Stowed	2.42 m
Length Stowed	1.18 m
Stowed Width	1.18 m
Wet Mass (full fuel tank)	995 kg
Length with Outriggers Extended	1.70 m
Width with Outriggers Extended	1.70 m
Mast Max. Elevation	8.30 m
Wind Speed Rating	80 km/hr

Power

Engine	Kubota Z482EG
Emission Level	Tier 4 Final
Fuel Type	Diesel
Fuel Consumption (litre per hour)	0.7
Running Time (hours)	245+
Generator	PM5G 48 V DC
Lights	4 x 300 W LED
Control System	Electronic Control
Noise Level @ 7m radius	< 60 dB(A)
Fuel Tank Volume	172 L

Mast System

Lift	Hydraulic
Mast Lift Time	20 seconds
Mast Lower Time	12 seconds
Rotate	340° Manual
Hydraulic System	
Voltage	12V
Pressure	240 bar (3,625 psi)
Pressure Relief Valve	125 bar (1800 psi)
Function Control	Electric over Hydraulic
Liquid Bunding	110%

Standard Features

- External Emergency Stop
- Bunding for all Fluids (110%)
- Electronic Module including Auto Stop / Start and Advanced Engine Management with Individual Light Switching
- Forklift Tyne Pockets
- Crane Lifting Points
- Long Extension Wind Down Outriggers
- 340° Rotation of Light Head
- Lockable Battery Isolator
- 1000 hour Engine Oil Service Interval
- 45° Light Tilt
- Level Indicator Bubble
- High Engine Temperature Cut-out
- Low fuel warning

Options Available

- 360° electro-mechanical lighthouse rotator
- 4.5 kg ABE Fire Extinguisher
- Double-pole battery isolator
- Starter motor isolator
- Anderson jump start receptacle
- Beacon
- Reflective tape
- Customised paint
- Exhaust heat wrap
- MDG-15 Spec



Dimensions

All dimensions are approximate.

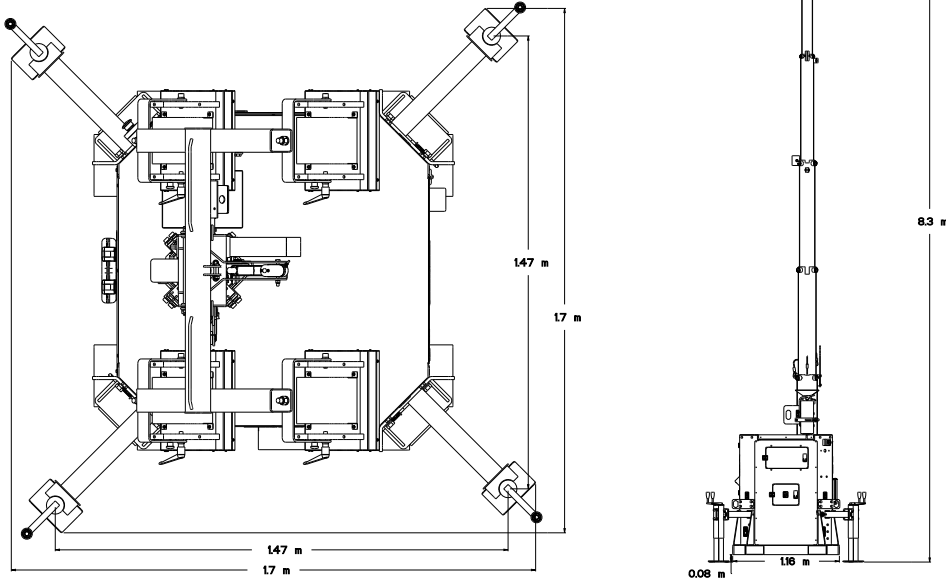

Isolux Plot

All dimensions are approximate.

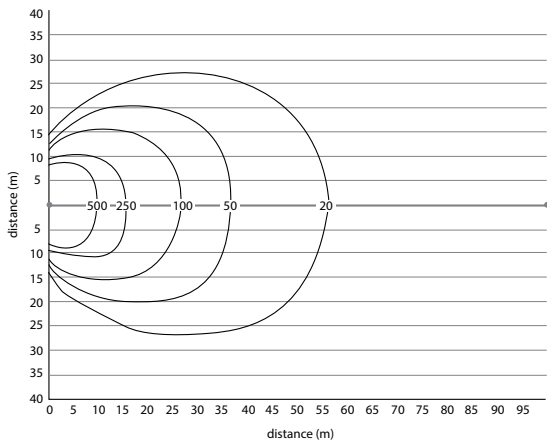

LT-CUBE Isolux Plot
[lm/m²]
4X JR 309-4M-300-DC48V

illumination
vertical plane
@ 1.0 m AGL
mast height
8.4 m



The JLG "1 & 5" Warranty

JLG Industries, Inc. backs its products with its exclusive "1 & 5" Warranty. We provide coverage on all products for one (1) full year and cover all specified major structural components for five (5) years. Due to continuous product improvements, we reserve the right to make specification and/ or equipment changes without prior notification.

R100620

JLG Industries (Australia)

358 Park Road
Regents Park, NSW 2143
Telephone 02 8718 6300
Fax 02 8718 6377

www.jlg.com.au

An Oshkosh Corporation Company